

Yoswit Smart Video Doorbell Datasheet

Model: YO172

Revised: 01-12-2024



Your All-in-One Home Guardian

Yoswit Smart Video Doorbell is equipped with a high-definition camera that delivers precise facial detection with remarkable accuracy, ensuring every visitor's face is clearly captured for enhanced security. Its wide-angle lens provides an expansive field of view, eliminating any blind spots. Additionally, the doorbell boasts exceptional night vision capabilities. In low-light or dark environments, it maintains clarity, allowing you to identify nocturnal visitors effortlessly. Plus, you can easily customize the volume to match your preferences and meet your household's needs. Experience unparalleled safety and convenience with the Smart Video Doorbell.

Connection:



Key Features and Benefits

- High-Definition Camera for Precise Facial Detection
- Expansive Field of View Eliminates Blind Spots
- Exceptional Night Vision for Low-Light Clarity
- Customizable Volume to Suit Your Preferences
- Wide Compatibility with Access Control Systems

Various Customized Products

We offer a comprehensive selection of smart home products that are seamlessly adapted to the usage standards and various socket types in different countries, ensuring a smooth installation process for all users. With extensive compatibility, our products enable you to control a diverse range of household appliances, including lighting, air conditioning, and TV.



Light Switch



Dimmer Switch



2 Way Switch



Double Pole Switch



Gate Controlled Switch



Hidden Controlled Switch



Outlet



Roller



Curtain



Remote Control



Thermostat

Yoswit App

You can download our app to implement the following functions via Bluetooth and WiFi to control the Yoswit switches.

Time Setting

Scene Mode

Device Network

Away Detection

Password Protection

Network Control

Apple Siri

Google Assistant



IFTTT

Depends on Yoswit Bridge Solutions.

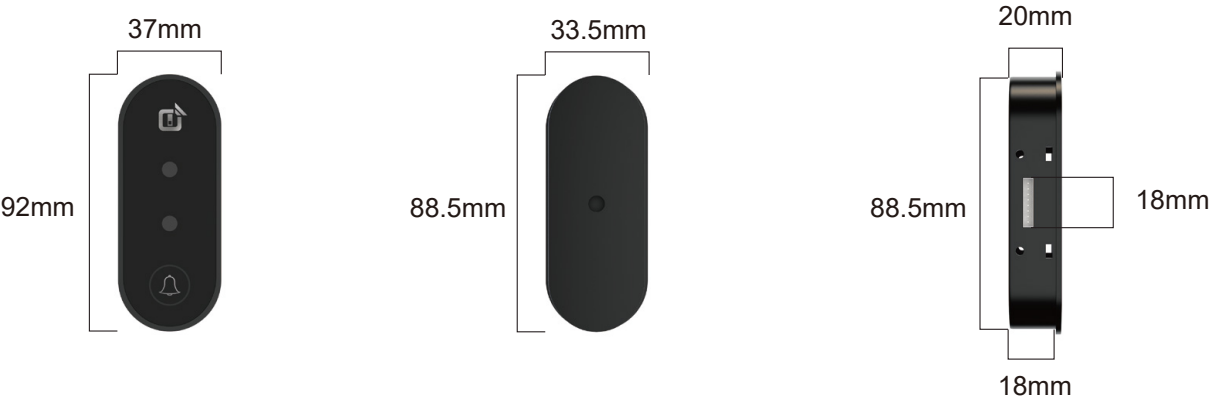

Product Specifications

Specifications:



General Specifications	
Product Name	Yoswit Smart Video Doorbell
Model	YO172
EAN / UPC	EAN: 0765756497749 / UPC: 765756497749
Revision	V1.0
Compliance	CE, FCC, RoHS
Manufacturer	Designed by Yoswit in Hong Kong, China / Assembled in Guangdong, China
Warranty	Two Year Limited Warranty (*Details available on the Product Warranty and Limitations of this datasheet)

Specifications	
Image Sensor	1/2.7 inch CMOS
Image Pixels	2M 1080p
Pixel Size	3.0um*3.0um
Video Output	MJPEG / YUY2
Lens	4.3mm
Field of View	73° No Distortion
Function	Support Infrared Light
Sleep Model Current	< 10mA
Working Current	< 300mA
Storage Temperature	-20°C to 75°C
Working Temperature	-20°C to 70°C

Maximum Frame Rates	MJPEG 1920*1080@30fps YUY2 1920*1080@30fps
SNR Max	≥40dB
White Balance	Auto, Manually
Exposure	Auto, Manually
Camera Control	Brightness, Saturation, Contrast, Sharpness, Hue, Definition, Gamma, Backlight Contrast, Gain
Digital Interface	5-pin 1.0mm USB2.0 No Driver
Transfer Rates	480Mb/S
Operating Voltage	DC5V

Product Package

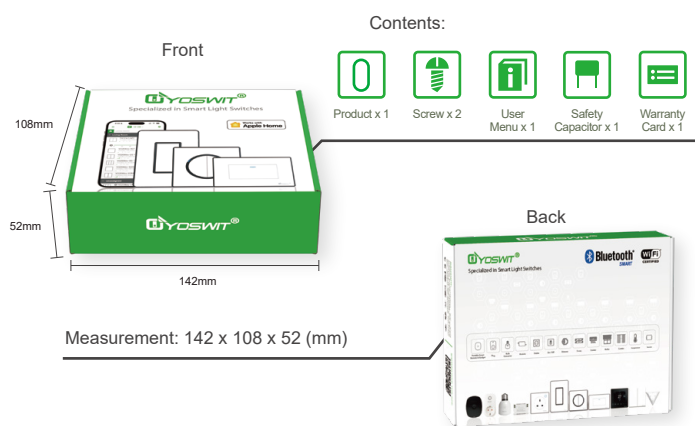

Outer Box



Quantity Per Box: 40 Pack / Box
Measurement: 58 x 31 x 23.5 (cm)

Product Warranty and Limitations

Yoswit brand products guarantee for a period of 2 years warranty from the date of purchase. During the warranty period and in the event that a defective product is identified (non-human factors), Yoswit will provide free maintenance. Damage beyond the warranty period or caused by improper use is not covered within the warranty, Yoswit will not bear any responsibility for repair, and will still provide users with a lifelong maintenance of paid services. If the products need to be repaired or returned to our company, an appropriate fee should be charged based on specific situation to cover the cost of replacement. Regardless of the warranty status, all shipping costs are borne by users.

LINCOGN TECHNOLOGY CO. LIMITED

Address: Room 202, 2/F, Building No. 19 West Science and Technology Avenue, Science Park, Shatin, N.T., Hong Kong
info@yoswit.com | Tel: (852) 3996 9396 | Fax: (852) 3119 8778 | www.yoswit.com